



EUROPEAN
CHAMPIONSHIPS
CYCLING
MUNICH 2022

TECHNICAL GUIDE

UEC BMX FREESTYLE PARK
EUROPEAN CHAMPIONSHIPS

MUNICH (GERMANY)

11 – 13 AUG 2022



DEAR CYCLING COMMUNITY,

Welcome to European Championships Munich 2022! Munich 2022 is the largest multi-sport event in Germany since the 1972 Summer Olympic Games. From 11-21 August, European sport unites as elite athletes compete for the highest accolade of their sport on the continent – the title of European Champion.

No other sport is as multifaceted, suitable for everyday life and appeals to such a wide range of audience as cycling does. With a jam-packed programme of track and road cycling, BMX freestyle park and MTB cross-country, Munich 2022 guarantees everything a cycling enthusiast could wish for and will showcase the beautiful Bavarian capital and all its spectacular surroundings.

The individual time trial takes place in neighbouring Fürstfeldbruck while road race cyclists will be treated to an extra dose of Bavarian charm, with the scenic lakes and mountains in Murnau a. Staffelsee and Landsberg am Lech providing a picturesque backdrop for the hotly anticipated race into Munich city centre.

MTB cross-country and BMX freestyle park competitors will also be at the heart of the action at Olympiapark – Munich 2022's central and pulsating hub. Furthermore, a purpose-built velodrome awaits competitors for the track events with space for 1,700 enthusiastic fans at Messe München.

The anticipation is rising here in Munich, and we cannot wait to showcase our wonderful venues to you all in August. Until then, we wish you all a safe, enjoyable, and healthy lead up to European Championships Munich 2022.

Best regards,

The Munich 2022 Local Organising Committee

CONTENT

DEAR CYCLING COMMUNITY.....	1
DISCOVER MUNICH'S TOP SITES	5
ORGANISATION	7
ADDRESS AND WEBSITE	7
LOCAL ORGANISING COMMITTEE.....	7
LOCAL ORGANISING COMMITTEE BMX FREESTYLE.....	7
UEC REPRESENTATIVES	7
GENERAL INFORMATION.....	8
TRAVEL AND ACCOMMODATION.....	8
NEAREST AIRPORT.....	8
ARRIVAL / DEPARTURE FROM AIRPORTS AND PICK-UP SERVICE	8
OFFICIAL BMX HOTEL.....	8
ACCOMMODATION	8
SHUTTLE BUS.....	8
PARKING	9
ACCREDITATION.....	9
TEAMS' / OFFICIALS' ACCREDITATION.....	9
DRIVING IN MUNICH	10
RIDERS' SAFETY ON THE ROADS.....	10
VISAS	10
SMOKING POLICY.....	10
MONEY.....	10
LANGUAGE.....	11
TAP WATER	11
ELECTRICITY.....	11
TELEPHONE.....	11
MEDICAL / EMERGENCY.....	11
HOSPITALS.....	11
URGENT MEDICAL CARE.....	12
EMERGENCY.....	12

MUNICH 2022 STUDY.....	13
COVID-19 REGULATIONS.....	13
SOCIAL MEDIA.....	14
USE OF DRONES	14
MUNICH 2022 OPENING	15
THE ROOFS.....	15
ATHLETES' ROOF	15
ATHLETES' TICKETS	15
SPECTATORS' TICKETS.....	16
SUSTAINABILITY.....	16
GENERAL INFORMATION.....	16
ACCESSIBILITY.....	16
WASTE MANAGEMENT	16
EUROPEAN CHAMPIONSHIPS MUNICH 2022 – SPORTS PROGRAMME	17
BMX FREESTYLE SPECIFIC INFORMATION.....	18
COMPOSITION OF THE OFFICIALS' PANEL.....	18
TEAM MANAGERS' MEETING.....	18
TEAM AREA	18
COMPETITION SCHEDULE.....	19
MIXED ZONE.....	19
ANTI-DOPING CONTROL.....	19
BMX FREESTYLE SPECIFIC REGULATIONS.....	20
RIDERS' CATEGORIES.....	20
SELECTION OF PARTICIPANTS.....	20
COMPETITION FORMAT.....	20
REGISTRATION AND RIDERS' CONFIRMATION.....	22
ONLINE REGISTRATION.....	22
RIDERS' CONFIRMATION	22
PRIZE MONEY	23
MAPS.....	24

OLYMPIAPARK MAP.....	24
VENUE MAP.....	25
BMX PARK MAP	26
BIRDVIEW	26
SIDEVIEW LEFT	26
SIDEVIEW RIGHT	27

DISCOVER MUNICH'S TOP SITES

MARIENPLATZ

The heartbeat of Munich: Marienplatz (St. Mary's Square), the world-famous centre of the Bavarian capital, is home to the New Town Hall. At any time of year, there's always something happening near Mariensäule (Column of St. Mary) – whether it's people gathering to witness the Glockenspiel (carillon housed in the Town Hall), the Christmas market, championship celebrations for major sports teams or simply visitors from all over the world strolling through the city.



NYMPHENBURG PALACE

Travel back in time to the age of the Bavarian monarchy: the extensive park with its pavilions, promenades along the palace canals, enormous fountains, magnificent flower gardens and, of course, impressive palace buildings is a source of fascination for Munich natives and tourists alike. In addition to the rooms inside the palace, which were designed by the best sculptors, painters and plasterers of the time, you can visit several museums housed in the palace itself, including the Museum of Man and Nature and the Museum of Nymphenburg Porcelain.



VIKTUALIENMARKT

Viktualienmarkt is Munich's largest market and a hub for the city's foodies. Spread across 22,000 square metres, it features a huge range of fresh produce with much more than just fruit and vegetables: Bakers, butchers, fishmongers, delicatessens, and flower stalls have turned Viktualienmarkt into a Munich landmark for more than 200 years. The best thing: Entry to the market is free with food stalls and a relaxing beergarden, complete with an authentic Bavarian maypole, awaiting.



HOFBRÄUHAUS

German “Gemütlichkeit” and traditional beer drinking rituals are paramount at the Hofbräuhaus on the Platzl square in Munich. The regional cuisine, music, folk dances, waiters in costume and historic atmosphere draw thousands of Munich natives and visitors from all over the world every day. The imposing Neo-Renaissance building remains a unique attraction. The interior has space to serve up to 3,000 guests, and additionally up to 400 seating places in the open-air beergarden outside. Doors open every day at 9:00, seven days a week.



DEUTSCHES MUSEUM

The largest technology museum in the world: The German Museum of Masterpieces of Science and Technology, as it's officially called, is both a traditional museum and a modern, hands-on facility. Visitors can enjoy demonstrations, experiments, and media stations, where they can press buttons, flip levers and switches and touch many of the exhibits. The 50 or so subjects covered by the museum are diverse, ranging from agriculture and food technology to astronomy, chemistry, photography and film, aeronautics and space technology, marine biology, and physics to shipping, telecommunications and even clocks.

ORGANISATION

ADDRESS AND WEBSITE

European Championships Munich 2022
LOC Office
Spiridon-Louis-Ring 22
80809 Munich
www.munich2022.com

LOCAL ORGANISING COMMITTEE

Managing Director Olympiapark GmbH	Marion Schöne (GER)
Head of LOC	Frank Seipp (GER)
Head of LOC	Markus Schnetzer (GER)
Head of Sports & Competition	Philip Frankenberger (GER)
Head of Event Services	Laura Mussgnung (GER)

LOCAL ORGANISING COMMITTEE BMX FREESTYLE

Project Manager BMX	Sophia Hasbach (GER)
Assistant Project Manager	Maxime Gierling (GER)
Sports Director	Andy Zeiss (GER)
Venue Manager Sport Venue	Sina Übelacker (GER)
Venue Manager Olympiapark	Mike Höhsl (AUT)

UEC REPRESENTATIVES

President	Enrico Della Casa (ITA)
Vice President	Henrik Jess Jensen (DEN)
Vice President	Delmino Albano Magalhães Pereira (POR)
Member	Katarina Jakubova (SVK)
Member	Dragomir Kouzov (BGR)

UEC General Secretary	Alasdair MacLennan (GBR)
UEC Sports Coordinator	Vladimiro Petsas (GRE)
UEC Events Coordinator	Tiziana Lardieri (SUI)

UEC Technical Delegate	Andy Zeiss (GER)
------------------------	------------------

UEC Press Officer	Stefano Bertolotti (ITA)
UEC Photographer	Roberto Bettini (ITA)
UEC Photographer	Luca Bettini (ITA)
UEC Video Operator	Christian Bohm (ITA)

GENERAL INFORMATION

TRAVEL AND ACCOMMODATION

Travel and accommodation expenses to and from Munich must be covered by the National Federations.

NEAREST AIRPORT

Munich Franz-Josef Strauss Airport; approx. 30 km away from Team Hotel
Nordallee 25, 85356 Munich

ARRIVAL / DEPARTURE FROM AIRPORTS AND PICK-UP SERVICE

All accredited teams, who booked accommodation through the LOC Munich 2022 will be provided with transportation from Munich Airport or the main train station to the hotel and vice versa. To make use of this service, you must register your arrival and departure dates via our Event Management System (EMS). The travel details deadline is 1 August 2022. During this process teams are also required to communicate if oversized luggage (e.g. bicycles) must be transported. If this data is not provided, the LOC will not take on responsibility of this matter. Olympiapark for BMX is situated 32 kilometres (30-minute drive) away from Munich Airport and Munich main train station is located five kilometres (15-minute drive) away.

Please update your arrival times in our EMS system (<https://ems.munich2022.com/#/login>), if any flights or trains dates change.

OFFICIAL BMX HOTEL

Star G Hotel Premium München
Weimarer Str. 2, 80807 Munich
GPS coordinates: 48° 11'04.6"N 11° 35'15.2"E
48.18460392596141, 11.587544869173335

ACCOMMODATION

Please note that all accredited teams that have booked accommodation through the Munich 2022 LOC still need to provide the personal data of all team members for the respective hotel rooms that have been booked. The deadline for accommodation booking by name is 1 August 2022 via our Event Management System (EMS). Please write a brief email to bmxfreestyle@munich2022.com if you require access to our Event Management System (<https://ems.munich2022.com/#/login>).

SHUTTLE BUS

All athletes that booked accommodation through the LOC will be provided with a shuttle service between the Star G hotel and the venue. The exact shuttle times will be communicated in the hotel and at the Team Area. An additional van for bikes and equipment will be provided for the shuttle rides. The shuttle stop is located at the bottom of Olympiaberg with a remaining walk to the venue of approximately 500 metres. The van for equipment and bikes will go all the way up to the venue.

PARKING

Limited team parking will be available in Olympiapark at the ice sports centre. If team parking is required, please contact the LOC via bmxfreestyle@munich2022.com.

ACCREDITATION

Each team member will receive a personalised accreditation card, which should be clearly visible and must be worn at all times. The holder is granted access rights ONLY to the zones indicated on the front and shall use the designated entrances accordingly.

Additionally, all BMX athletes will receive wristbands which allow access to the field of play as well as the BMX Team Area. Please note that this wristband is not a full replacement for an accreditation. For all other zones, including the Athletes' Roof, a regular accreditation card will be needed.

ACCREDITATION ZONES	
Zone	Area
1	Field Of Play
2	Athletes' Area
3	Warm-Up Areas
4	Training Area
5	Administrative And Operational Area
6	Media Area
7	Media Mixed Zone
8	Broadcasters' Areas
9	VIP Hospitality

In the event of a lost accreditation card, a fee of €100 will be charged for the replacement which will be settled via the respective team invoice.

TEAMS' / OFFICIALS' ACCREDITATION

All national teams' and officials' accreditations can be collected during the riders' confirmation at the following location:

Riders' Confirmation tent in front of the Main Accreditation Centre (ice sports centre)
 Olympiapark München, Spiridon-Louis-Ring 3, 80809 Munich
 GPS coordinates: 48° 10'28.5"N 11° 33'29.7"E
 48.17458455715417, 11.55824418568666

at the following date:

Tuesday, 9 August

13:00 – 16:30

Please ensure that you collect your accreditation before arriving at the venue as it will be required for access to all parts of the venue. Accreditations must be worn and visible whenever you pass through accreditation controls.

DRIVING IN MUNICH

Please remember to follow German traffic laws, including the Sunday and holiday driving ban for trucks heavier than 7.5 tons and obtain the environmental badge needed for driving in Munich's city centre. Environmental zones are indicated with a traffic sign "Umwelt ZONE." An additional sign underneath then specifies what type of environmental badge you need. You may have to pay a fine of up to €80 if you enter these eco zones without a valid environmental badge. Please refer to this link: <https://www.germanemissionssticker.com/> for more information.

RIDERS' SAFETY ON THE ROADS

- Whilst out on the roads, do not ride on the motorway or main roads
- After dark you are required by law to have a front and back light fitted to your bike
- Ensure you adhere to all road signs and do not ride on footpaths; this is illegal and may result in a fine
- Please make sure you have your ID with you when you are away from the venue

VISAS

Citizens of the European Union and the Schengen Area are not required to apply for a visa when entering Germany. However, residents from the following countries must apply for a visa at an embassy of the Federal Republic of Germany: Albania*, Armenia, Azerbaijan, Bosnia and Herzegovina*, Georgia*, Kosovo, Moldova*, Montenegro*, North Macedonia*, Serbia*, Turkey and Ukraine*. If invitation letters are required, the LOC will gladly provide the required document. (Please contact bmxfreestyle@munich2022.com in this regard)

*Only if the national citizen does not hold a biometric passport.

All participants must hold a valid passport or identity card. Visa obligations must be respected.

All riders and attendants must hold insurance valid in Germany.

SMOKING POLICY

Smoking in public buildings and on public transport is prohibited.

MONEY

The official currency in Germany is the Euro (€, code: EUR). Cash machines (ATMs) can be found in front of banks, supermarkets, and frequented public places/areas. Additionally, many supermarkets offer cash withdrawals at their checkouts. You normally receive a notification if the transaction includes a charge for the withdrawal. Most shops and restaurants accept debit and credit cards.

LANGUAGE

The national language is German.

TAP WATER

Tap water can be consumed safely unless otherwise indicated/signposted.

ELECTRICITY

Standard power sockets operate at 230 volts. A Type C, also called the Europlug, or a Type F, also called Schuko, plug or converter is required to use electrical appliances.

TELEPHONE

The country code for Germany is +49.

MEDICAL / EMERGENCY

Medical service will be provided at the official competition, warm-up, and training venues. Trained medical staff will be in place during the opening hours at all official venues.

If a medical emergency occurs, please search for the next medical centre, or approach the nearest medical team.

HOSPITALS

To provide the best care for athletes in case of injuries, the medical service provider has a list of hospitals, where all athletes of the European Championships Munich 2022 will get preferred treatment.

This service is set in place and will be communicated via the medical director or the medical service provider at all official venues.

Augustinum

Cardiology

Wolkerweg 16

81375 Munich

+49 89 70970

Klinikum der Barmherzigen Brüder München

Gastroenterology, Cardiology, Orthopaedics, Sport Orthopaedics, Surgery, Trauma Surgery

Romanstr. 93

80639 Munich

+49 89 17970

Klinikum rechts der Isar

Gastroenterology, Cardiology, Orthopaedics, Sport Orthopaedics, Surgery, Trauma Surgery, Neurology, Ophthalmology, Mouth Jaw & Facial Surgery, Neurosurgery, Gynaecology, Haemato-oncology

Ismaninger Str. 22

81675 Munich

+49 89 41400

Präventive Sportmedizin und Sportkardiologie der TU München

Sports Medicine

Georg-Brauchle-Ring 56/58

80992 Munich

+49 89 28924441

Schönklinik Harlaching

Orthopaedics

Harlachinger Str. 51

81547 Munich

+49 89 62112244

URGENT MEDICAL CARE

Outside the official opening hours at the official venues, there is a 24/7 on-call number available for all athletes. This number can be called if medical advice is needed.

On-call number: +4989200045640

For urgent medical emergencies, which occur outside of competition or training call 112.

EMERGENCY

Those are the emergency numbers, which should be dialled in case of a particular emergency:

Police: **110**

Fire brigade and Ambulance: **112**

In case of emergency make sure to follow these five aspects:

- Where are you? Where is emergency care required?
- What happened or is happening?
- How many people are affected?
- What type of damages or injuries are occurring?
- Wait for further queries or consultation!

MUNICH 2022 STUDY

This study is about injuries and illnesses during and just before a multi-sport event. During the European Championships, the study team will collect anonymous data about injuries and illnesses during training, warm-up, and competition.

A study team will be present at the medical centre of all official venues and will document the injuries and illnesses. The aim of the study is a better care for athletes during multi-sport events. It is important to ensure better planning for athletes and organisers with a scientific foundation.

COVID-19 REGULATIONS

Entry and quarantine regulations

Information for all participants from abroad:

- As of June 1, entrants no longer need proof that they have been vaccinated, recovered or tested.
- Exception: entry from a virus variant area. Here, the existing strict registration, proof and quarantine regulations still apply.

For participants after stays in virus variant areas applies:

- An electronic entry registration (<https://www.einreiseanmeldung.de>).
- A quarantine obligation of 14 days, also with vaccination or proof of recovery.

General recommendations for behaviour

The legislator describes the following general behavioural recommendations in the current Infection Protection Measures Ordinance:

Distance

Wherever possible, a minimum distance of 1.50 m should be maintained.

Hygiene measures

Hygiene rules should be observed at all times. This includes frequent and thorough hand washing as well as coughing and sneezing into the crook of the arm or into a paper handkerchief in everyday life.

Wear a mask

Especially indoors or if a distance of 1.50 m from others cannot be safely maintained, a FFP2 mask should be worn.

Ventilation of indoor areas

In closed rooms, care should be taken to ensure adequate ventilation

FFP2 mask

It is recommended to wear a FFP2 mask indoors and in transport vehicles during the European Championships Munich 2022.

Sufficient FFP2 masks will be provided to the participants. The FFP2 masks are to be worn only for single use or for the duration of one working day and then disposed of.

In outdoor areas it is recommended to always keep the minimum distance of 1.50 m between each other.

Hand hygiene

For thorough hand hygiene, frequent hand washing (30 seconds with soap and water, followed by thorough rinsing) is recommended.

Sufficient disinfection dispensers are available for the use of hand disinfection, e.g. before entering and when leaving the venues.

Management of suspected Covid 19 cases and confirmed infections

If Covid19 infection is suspected, daily testing services are available to athletes and their teams.

If there is a positive result from an antigen test, the affected person should undergo PCR testing and be placed in isolation until the result is known.

Currently, the isolation period after a positive Corona test is 5 days. Access to the sports facility is then possible again if symptoms are absent for 48 hrs. If symptoms persist, isolation must be continued until signs of acute COVID-19 disease have been absent for 48 hours, but for a maximum of 10 days.

"Close contacts" only need to be in isolation if they have also tested positive, according to the current regulation.

SOCIAL MEDIA

Munich 2022 encourages and fully supports athletes, as well as other accredited persons, to engage in social media activities throughout the duration of the European Championships. Munich 2022 wants as many athletes and team staff as possible to share their experiences and successes at the European Championships.

It is important, though, to note the following:

Athletes and team staff do not have the right to publish any video footage filmed in competition areas. All social media activities should be in a first-person, diary-type format and not in the role of a journalist, for example reporting competitions. If team staff want to film and publish non-live/delayed video material (that does not contain competition footage) from the Mixed Zone, they require prior approval as a Non-Rights Holder.

In addition, they should not:

- Intrude upon the privacy of participants or other accredited persons and entities
- Interfere with the competitions or the ceremonies of the European Championships
- Violate security measures

Please feel free to tag official Munich 2022 channels in all your posts using the official hashtags **#Munich2022** and **#BackToTheRoofs**:

Facebook: [@ECMunich2022](https://www.facebook.com/ECMunich2022)

Instagram: [@munich2022](https://www.instagram.com/munich2022)

Twitter: [@ECMunich2022](https://twitter.com/ECMunich2022)

LinkedIn: [European Championships Munich 2022](https://www.linkedin.com/company/european-championships-munich-2022)

YouTube: [Munich 2022](https://www.youtube.com/channel/UCMunich2022)

USE OF DRONES

The use of drones is prohibited during all cycling competitions and training times at European Championships Munich 2022.

MUNICH 2022 OPENING

The official opening of European Championships Munich 2022 will take place in Olympiapark on 10 August 2022, ringing in and raising the excitement for 11 action-packed days of sports and festival. The programme is based on the organisers' overall vision of creating a unique event experience for everybody, providing memorable moments of happiness.

THE ROOFS

The Roofs is a festival of diversity and surprise accompanying the European Championships with a mix of music, culture, art, food and much more. Combining big-name headliners with a lovingly curated programme, The Roofs creates special moments that make Munich 2022 a holistic event experience. The festival is made up of 11 Roofs, each with their own character and charm. There's something on offer for young and old alike. Plus, the entire programme is free of charge.

ATHLETES' ROOF

The Athletes' Roof, featuring the Red Bull Energy Station, will be the go-to spot for all athletes competing at European Championships Munich 2022. Hanging out with teammates, recharging after the competition, watching events live, cheering on compatriots or getting to know other athletes from all over Europe – the Energy Station underlines and bundles the beauty of the multi-sport European Championships. There is something on offer for everyone to savour the Munich 2022 experience, and much, much more. The outdoor chill-out area awaits with additional varied activities. Stay tuned! The Athletes' Roof in Olympiapark will be open daily from 10–21 August; the exact opening hours will be communicated shortly. We cannot wait to host you!

ATHLETES' TICKETS

In the spirit of the multi-sport event, accredited athletes will have the opportunity to attend events of all nine sports free of charge. Please note that the number of available seats depends on the capacity and occupancy of the venues.

Reservations are generally not possible, and access will be granted on site and is subject to availability. In general, no tickets will be issued. On site, the athlete can enter the venue through a specially assigned entrance (usually located at the main entrance). Admission will be granted upon presentation of a valid European Championships Munich 2022 accreditation.

There is no pre-determined entitlement to a seat. As soon as the ticket holder claims their seat, the athlete must give up the seat and find an alternative available seat. In most venues there will be a designated area for athletes.

The current sales status is viewable in the European Championships 2022 web shop. By clicking on the corresponding session, the current availability can be checked. In general, a distinction is made as follows:

Available (High probability of access to the respective event)

Limited availability (The probability of access to the event is limited and cannot be guaranteed on site)

Not available (Access to the respective event is not possible)

Ticket availability is fluid and can change at short notice, therefore access is not guaranteed.

To allow other athletes access to the venue, it is important to use the exclusive entrance when leaving the venue. This will ensure that the ticketing volunteer frees up a space in the system and another athlete can attend the event.

SPECTATORS' TICKETS

As a multi-sport event, European Championships Munich 2022 hosts nine different sports. Although BMX Freestyle is one of the non-ticketed events, there's numerous sports you can enjoy and buy tickets for. Please visit munich2022.com/tickets for ticket information and don't hesitate to share this information with your contacts.

SUSTAINABILITY

GENERAL INFORMATION

As LOC we are aware of our responsibility towards nature, society and the economy and are committed to actively contribute to local and global sustainability. We have developed a sustainability strategy that prioritises six focus areas: (1) Reuse of sports facility and equipment, (2) transport and mobility, (3) waste and littering, (4) impact on grassroots and professional sports, (5) inclusion and accessibility, (6) local value creation. The sustainability strategy was published in November 2021 and the sustainability post-event report will follow in December 2022. Questions can be directed to countandlast@munich2022.com regarding sustainability.

ACCESSIBILITY

Please contact inclusion@munich2022.com for any accessibility/mobility assistance queries.

WASTE MANAGEMENT

Our waste management is based on the principles: rethink, reduce, reuse, recycle. In this sense, together we are trying to produce the smallest amount of waste as possible and avoid littering. For recycling we will set up waste stations to sort waste by type. Additionally, standard bins will be placed at the venue for residual waste collection. Everyone attending is encouraged to use the recycling waste stations and bins throughout the venue.



EUROPEAN CHAMPIONSHIPS MUNICH 2022 – SPORTS PROGRAMME

SPORT / DISCIPLINE	VENUE	11 THU	12 FRI	13 SAT	14 SUN	15 MON	16 TUE	17 WED	18 THU	19 FRI	20 SAT	21 SUN
Athletics	Olympiastadion					▶▶	▶▶	▶▶	▶▶	▶▶	▶▶	▶▶
Athletics Marathon	Munich City Centre					▶▶						
Athletics Race Walking	Munich City Centre						▶▶				▶▶	
Beach Volleyball	Königsplatz										▶▶	▶▶
Canoe Sprint	Munich Olympic Regatta Centre										▶▶	▶▶
Cycling Track	Messe München		▶▶	▶▶	▶▶	▶▶	▶▶					
Cycling Road	Munich City Centre			▶▶				▶▶				▶▶
Cycling Mountain Bike	Olympiapark									▶▶	▶▶	
Cycling BMX Freestyle	Olympiapark		▶▶	▶▶								
Artistic Gymnastics	Olympiahalle	▶▶		▶▶	▶▶				▶▶			▶▶
Rowing	Munich Olympic Regatta Centre			▶▶	▶▶							
Sport Climbing Boulder	Königsplatz			▶▶	▶▶							
Sport Climbing Lead	Königsplatz			▶▶	▶▶							
Sport Climbing Speed	Königsplatz					▶▶						
Sport Climbing Boulder & Lead	Königsplatz							▶▶	▶▶			
Table Tennis Doubles	Rudi-Sedlmayer-Halle					▶▶			▶▶			
Table Tennis Singles	Rudi-Sedlmayer-Halle											▶▶
Triathlon	Olympiapark		▶▶	▶▶								
MEDAL EVENTS		1	8	21	24	14	12	9	10	20	23	35

BMX FREESTYLE SPECIFIC INFORMATION

COMPOSITION OF THE OFFICIALS' PANEL

Head Judge	Dave Cleworth (GBR)
Judge	Axel Jürgens (ESP)
Judge	Luka Kovic (SLO)
Judge	Markus Wilke (GER)
Judge	Igor Vukadinovic (CRO)
Judge	Christie Lou (GBR)
Technical Delegate	Andy Zeiss (GER)
Sports Director	Andy Zeiss (GER)
Project Manager BMX	Sophia Hasbach (GER)
Assistant Project Manager BMX	Maxime Gierling (GER)

TEAM MANAGERS' MEETING

Tuesday, 9 August

17:00 – 18:00

in the following location:

Team Area BMX next to Olympiaalm (Olympiaberg)
Olympiapark München, Martin-Luther-King-Weg 8, 80809 Munich
GPS coordinates: 48° 10' 14.7"N 11° 33' 17.6"E
48.170739736287906, 11.554875943450075

Due to the health protocol and sanitary measures put in place, we ask you to limit participation in the Team Managers' Meeting to one (1) representative per nation.

TEAM AREA

The BMX Athletes' Lounge is located on Olympiaberg, with a distance to the field of play of approximately 40 metres. The Athletes' Lounge provides drinks and snacks and team tables for each participating federation as well as changing rooms with lockers, a small chill-out area, and an outside area with a view on the field of play. Moreover, there will be a small Team Area directly at the field of play.

COMPETITION SCHEDULE

Tuesday, 9 August

- 13:00 – 16:30 Riders' Confirmation
- 17:00 – 18:00 Team Managers' Meeting

Wednesday, 10 August

- 10:00 – 14:30 Training Women
- 15:00 – 19:30 Training Men

Thursday, 11 August

- 10:00 – 12:00 Training/Warm-Up Women
- 12:00 – 13:20 Qualification Women Group 1
- 13:45 – 15:05 Qualification Women Group 2
- 15:20 – 17:00 Training/Warm-Up Men
- 17:00 – 18:20 Qualification Men Group 1
- 18:45 – 20:05 Qualification Men Group 2

Friday, 12 August

- 13:15 – 15:15 Training/Warm-Up Women
- 15:15 – 16:15 Final Women
- 17:30 – 19:30 Free Training Men

Saturday, 13 August

- 17:00 – 19:00 Training/Warm-Up Men
- 19:00 – 20:00 Final Men

MIXED ZONE

At the exit area of the field of play, Munich 2022 will organise a Mixed Zone. All riders must pass through this Mixed Zone where media can interview them. Riders are encouraged to talk to the media representatives in the Mixed Zone but are under no obligation to talk to them.

LOC Communications representative: Manuel Deutschmeyer - manuel.deutschmeyer@munich2022.com

LOC Media Operations representative: Melanie Listl – melanie.listl@munich2022.com

ANTI-DOPING CONTROL

The Anti-Doping centre is situated in Olympiahalle. A chaperone will accompany the respective athletes to the shuttle stop at the bottom of Olympiaberg, from where they will be picked up by a golfcart. A shuttle back to the Star G hotel may be provided in case all regular shuttles are missed.

Doping Control Officers are appointed by PWC (Professional Worldwide Controls).

BMX FREESTYLE SPECIFIC REGULATIONS

RIDERS' CATEGORIES

6bis.2.001

For participation in events on the international calendar, riders' categories are determined by the age of those competing. A rider's age is defined by the difference between the year of the event and the year of birth of the rider, as defined in article 1.1.034.

6bis.2.002

UCI Categories for BMX Freestyle Competitions:

1. Categories for Men: Men Elite, aged 15 and over
2. Categories for Women: Women Elite, aged 15 and over

SELECTION OF PARTICIPANTS

In accordance with the UCI rules only European riders can participate in a European Championships (CC) competition. All riders must hold a national licence issued by an UCI affiliated federation.

The maximum number of riders in each above-mentioned category is 30 riders.

Selection procedure before the first deadline:

Every European Federation can register two riders in each category before the first registration deadline. This means a federation can register a maximum of 2 Men Elite and 2 Women Elite riders for each category.

Selection before the second deadline:

If spots are still available, the highest ranked nations will have an opportunity to take an extra available spot in each category. Starting with the highest ranked nation, a nation has the chance to take another spot until the total spots of 30 are taken, each country has a maximum of 3 quota.

Example:

After the first registration deadline 23 spots in Men Elite were taken. Based on the nation ranking of 24 May 2022, France is the first country which has the opportunity to take an extra spot, followed by Great Britain and Croatia. Federations can register their third rider before the second deadline.

The categories will be filled up until the 30 spots are taken.

Note: This ranking just serves as an example. The actual ranking, which will be used, will be based upon the latest updated version of the UCI ranking after 5 July 2022.

COMPETITION FORMAT

6bis.6.003

A BMX freestyle competition for each category may be composed of the phases (Qualification, Semi-final or Final) described below, and within each phase, several heats.

For park competitions, a heat is a group which comprises 4-6 riders.

The combination of phases and heats (if applicable) for a category depends on the number of entries and is found in the following table.

Park Competition

Number of entries	Competition phases	Qualification rule	Number of heats
5 - 8 entries	2 phases: Qualification x 1 Final x 1	Top 4 in Qualification advance to Final	Qualification: as below 1 heat of 4 in Final
9 – 15 entries	2 phases: Qualification x 1 Final x 1	Top 8 in Qualification advance to Final	Qualification: as below 2 heats of 4 in Final
16 - 31 entries	2 phases: Qualification x 1 Final x 1	Top 12 in Qualification advance to Final	Qualification: as below 2 heats of 6 in Final
More than 31 entries	3 phases: Qualification x 1 Semi-final x 1 Final x 1	Top 24 in Qualification advance to Semi-final Top 12 in Semi-final advance to Final	Qualification: as below 4 heats of 6 in Semi-final 2 heats of 6 in Final

Number of heats

The number of heats in each round is found in the table above. For the qualification phase, the number of heats should be chosen such that as many heats as possible have 4-6 riders. Whenever it is not possible for all heats to have 6 riders, a number of heats will have either 4, 5 or 6 riders. By preference, heats should be formed with the highest number of riders possible. Any heats that do not have 6 riders, will be at the start of the heat order.

6bis.6.004

A run is the individual unit of competition in a BMX freestyle event, during which a rider performs a routine consisting of various tricks, which is evaluated by the judges.

Park Competitions

At all phases of the competition, within each heat, each rider shall do 2 runs.

In general, riders do their first run in the start order defined in article 6bis.6.005. Once the final rider in the order within each heat has taken their first run, the riders will do their second run in the same order.

Start Order

6bis.6.005 Qualification Phase Park Competitions

Within the qualification phase, riders are randomly assigned to each heat.

However, in case an event that is part of a series, the qualification phase shall instead be done in reverse order of the current series ranking; that is, riders are assigned to their heats in order, starting with the unranked or lowest ranked riders and ending with the highest ranked riders in the last heat.

In such a case, within each heat, the start order continues to be in reverse order of ranking, so that the highest ranked rider within each heat goes last in that heat. Any unranked riders are seeded randomly in the first heats in the order.

In case of the first event in a series, the final ranking of the previous season of the series will be used.

6bis.6.007

Within the final phase, the start order is in reverse order of the results of the preceding phase.

6bis.6.008

Within each phase of the competition, the riders in each heat are entitled to a warm-up before their heat begins.

Park Competitions: a minimum 40 second warm-up must be given.

In the final, any rider who is not present within the park or the rider's area as described in the technical guide at latest by the start of the 15-minute warm-up period preceding that phase, shall not be allowed to start. They will be scored as DNS ("Did Not Start") for the phase in question.

6bis.6.009

In case one or more riders do not start in a semi-final or the final for the reason of missing the deadline described in article 6bis.6.009, the heats shall be redrawn as described in article 6bis.6.003.

6bis.6.010

In case one or more riders withdraw (or are disqualified or refused their start) once the deadline described in article 6bis.6.009 has passed, the heats will not be changed.

REGISTRATION AND RIDERS' CONFIRMATION

ONLINE REGISTRATION

Registration in the Men Elite and Women Elite categories shall be done by pre-registration only. Once the pre-registration deadline has passed, no further entries shall be accepted.

The online registration system will open: 27 June 2022

First deadline to claim 2 spots: 11 July 2022

Second deadline: Federations will be contacted if they are allowed to send a third rider.

Pre-registration closes: 25 July 2022

Through the UEC website (www.uec.ch) clicking as follows: <http://www.uec.ch/en/registrations>

Access: Personal login and password of each National Federation.

Remark: The name of the hotel where the riders will stay overnight and the name/contact information of the team manager for each National Federation must be given during riders' confirmation.

RIDERS' CONFIRMATION

The participation of all riders entered in the UEC BMX Freestyle Park European Championships must be confirmed during riders' confirmation. To ensure his/her participation, either the rider him-/herself or the team manager for his/her country must go to rider's confirmation.

No further entries shall be accepted following the end of riders' confirmation. Likewise, any riders who entered but did not attend the riders' confirmation, shall be removed from the list of entries, and not allowed to start.

The initial confirmation of riders will be organised on:

Tuesday, 9 August at the following time: 13:00 – 16:30

In the following location:

Riders' Confirmation tent in front of the Main Accreditation Centre (ice sports centre)
Olympiapark München, Spiridon-Louis-Ring 7, 80809 Munich
GPS coordinates: 48° 10'28.4"N 11° 33'29.3"E
48.17455209008297, 11.558133201889792

Registration regulations

A valid cycling licence, as defined in part I of the UCI regulations will be required and must be presented at riders' confirmation to check their identity. An identity card or passport is also mandatory. Once all the terms of the registration are completed, the organisation will give riders a wristband allowing them to enter the competition area. A rider whose licence could not be verified and whose status as a non-suspended licence holder cannot be established in any other manner may not start and may not figure in the classification of the event.

Entry in the competition implies agreement with the event schedule, regulations and all provisions of the technical guide.

Training

Training groups will be set up following the last update of the UCI Individual Ranking. In case of a delayed flight, luggage loss or delay, sickness or any other reason that prevents you to train in the group in which you are assigned, please contact us by bmxfreestyle@munich2022.com.

Riders must be completely registered before beginning their first practice; they are not allowed in the competition venue until they are completely registered.

PRIZE MONEY

The prize money will be transferred by the UEC directly to the riders' National Federation.

	Men Elite	Women Elite
1	€ 1000	€ 1000
2	€ 650	€ 650
3	€ 350	€ 350
4	€ 300	€ 300
5	€ 250	€ 250
6	€ 200	€ 200
7	€ 175	€ 175
8	€ 160	€ 160
	€ 3085	€ 3085

The medal ceremony will take place on the field of play just after the end of each final. Be sure to stay on the park for the announcement of the final results.



MAPS

OLYMPIAPARK MAP

EUROPEAN
CHAMPIONSHIPS
CYCLING
MUNICH 2022



OLYMPIAPARK OVERVIEW

LEGENDE

1. Start / Finish Triathlon / MTB
2. Athletes' Roof
3. Anti-Doping Control
4. Riders' Confirmation
5. Shuttle Stop





VENUE MAP



OLYMPIABERG – VENUE BMX FREESTYLE

GPS: 48.16998876257064, 11.553934020001867

LEGENDE

- 1. Heimat Roof (Beergarden)
- 2. VIP
- 3. Team Area
- 4. Toilet
- 5. Medical Tent
- 6. Public Medical Tent
- 7. Public Toilet
- 8. Judges
- 9. Mixed Zone
- 10. Wheelchair Area
- 11. Media
- 12. Offices

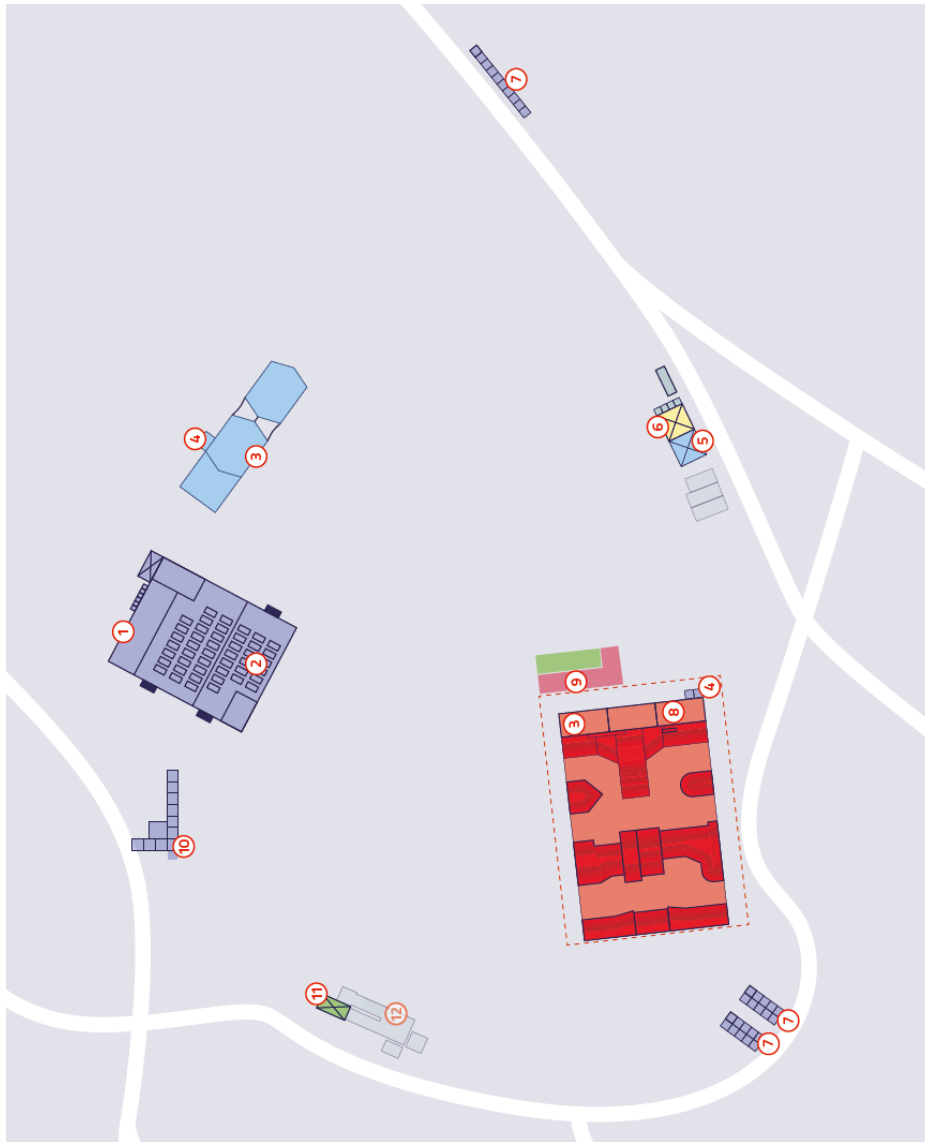

BMX PARK MAP

BIRDVIEW

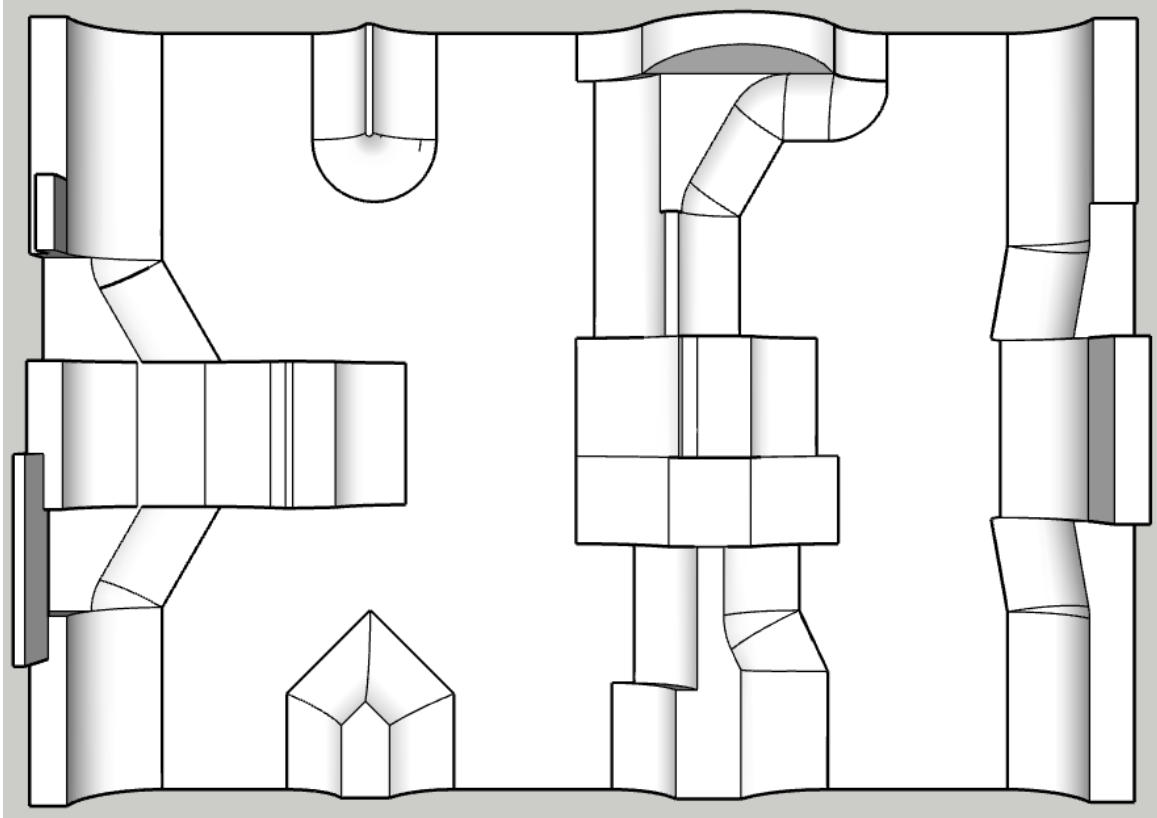

SIDEVIEW LEFT

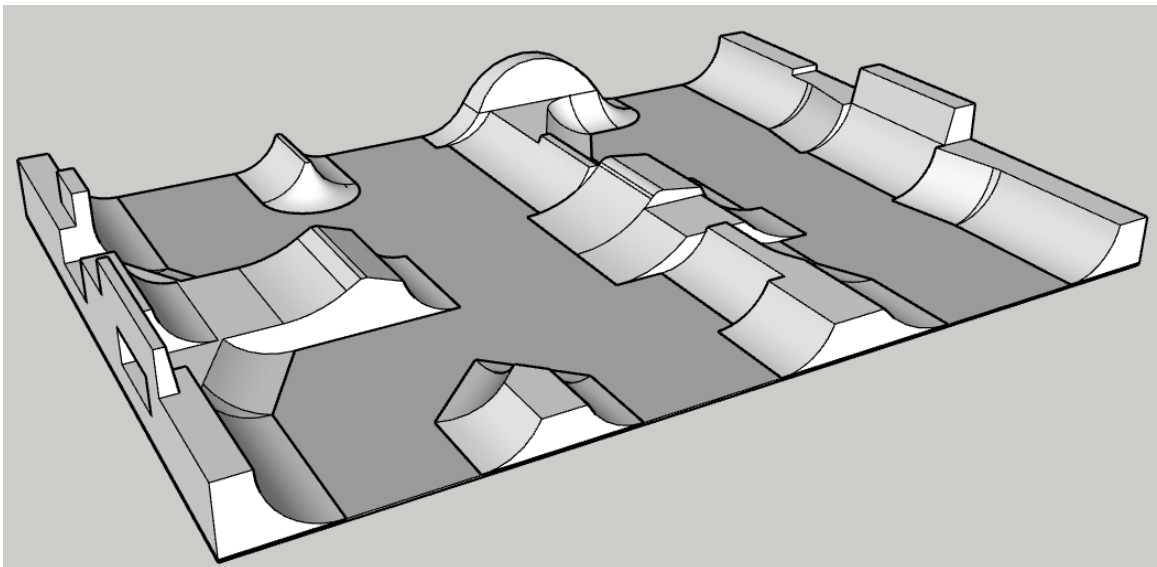



SIDEVIEW RIGHT

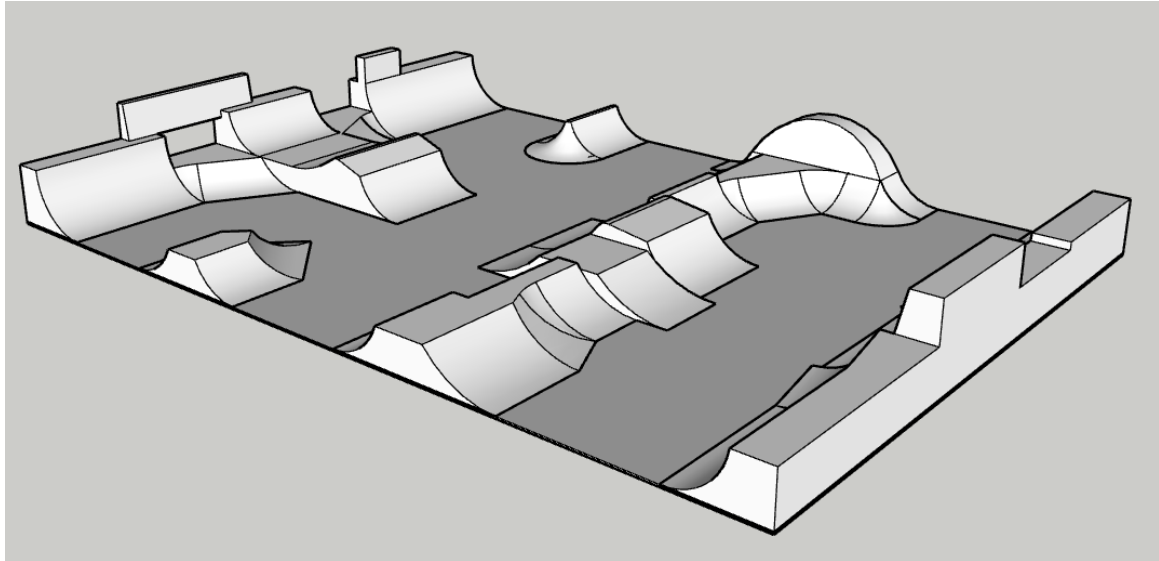



THANK YOU TO OUR PARTNERS

OFFICIAL PREMIUM PARTNERS



FEDERATIONS



HOST INSTITUTIONS

Funded by the



Funded by
Bavarian State Ministry of the
Interior, for Sport and Integration

funded by the
City of Munich



OLYMPIAPARK
MÜNCHEN

EUROPEAN CHAMPIONSHIPS MANAGEMENT



BROADCAST

